

Room 30 ft. x 35 ft.

**Conference
Configuration
Maximum (28) people
seated at tables**

(75) Chairs
1'9"x1'9"
footprint



(20) Desk
Tables 5'x4'
one-sided.
Seats 2 people
per table

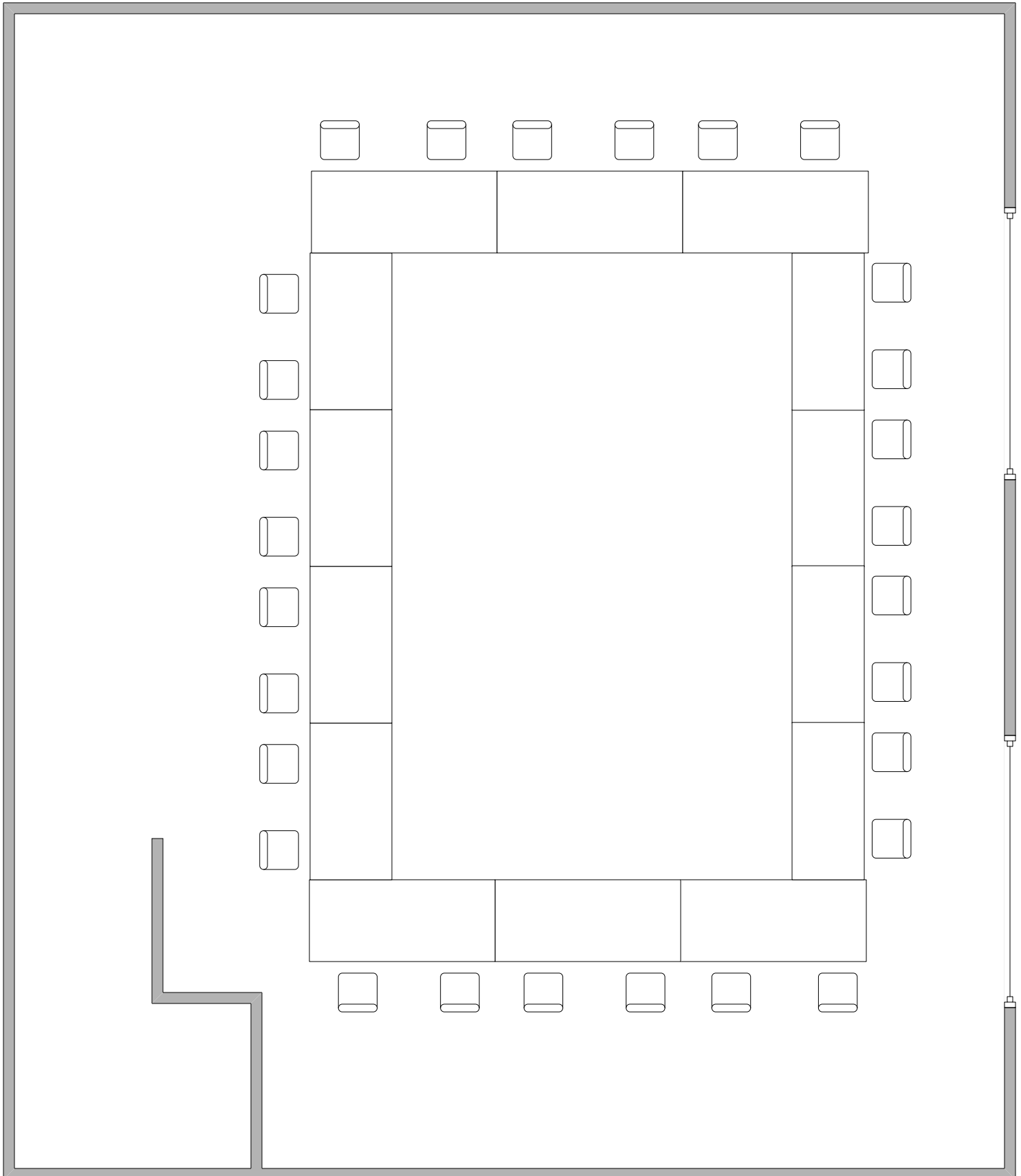

**Boardroom
Configuration
Maximum (40) people
seated at tables**

(75) Chairs
1'9"x1'9"
footprint



(20) Desk
Tables 5'x4'
one-sided.
Seats 2 people
per table

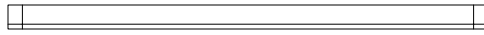

Projection
Drop Screen

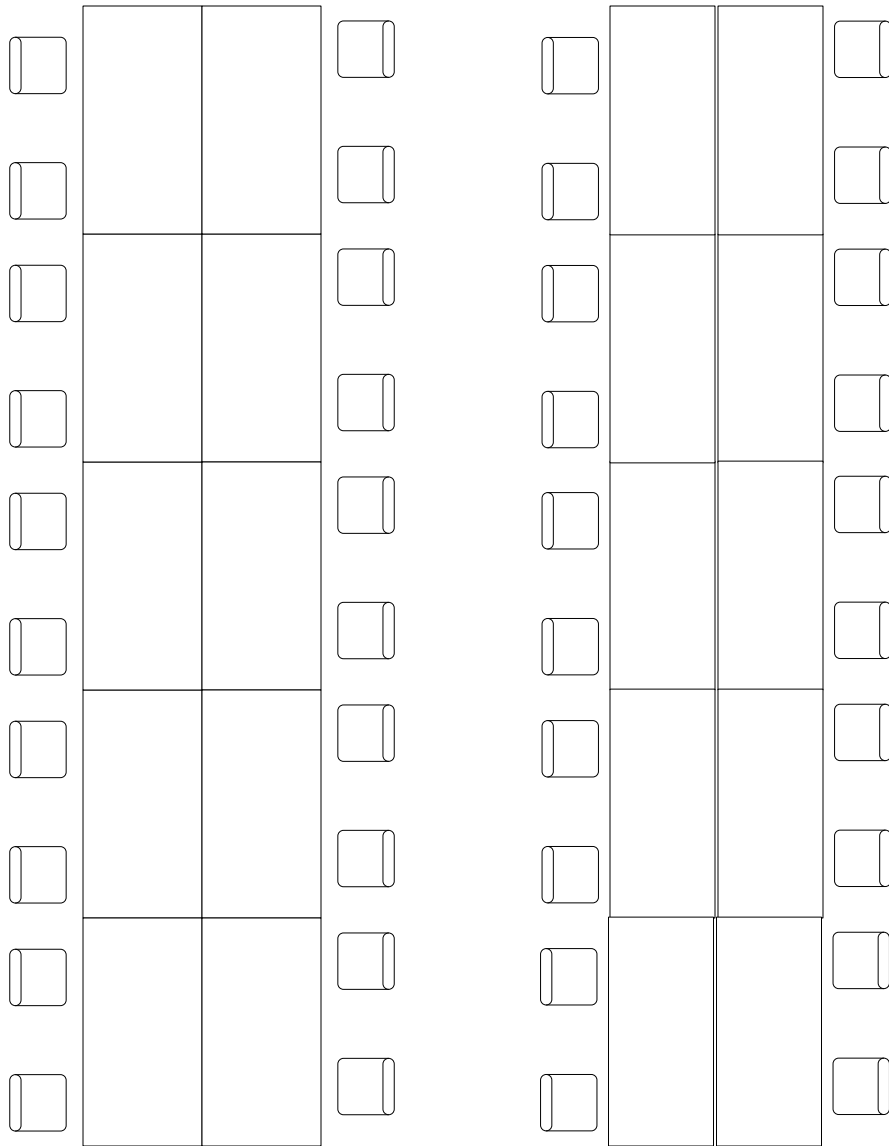

**U-Shaped
Configuration
Maximum (22) people
seated at tables**

(75) Chairs
1'9"x1'9"
footprint



(20) Desk
Tables 5'x4'
one-sided.
Seats 2 people
per table

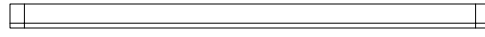

Projection
Drop Screen

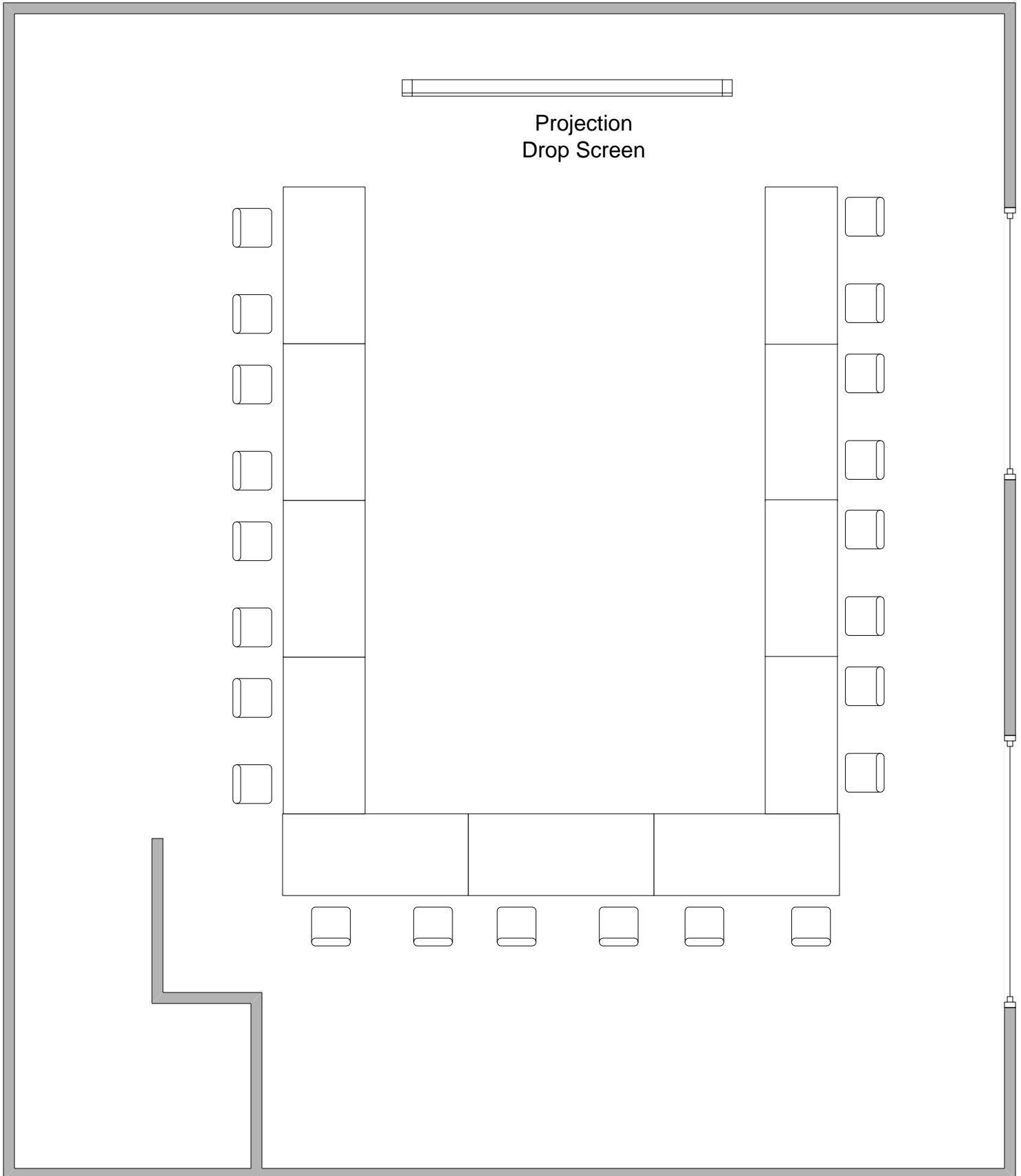

**Classroom
Configuration**
Maximum (40) people
seated at tables

(75) Chairs
1'9"x1'9"
footprint



(20) Desk
Tables 5'x4'
one-sided.
Seats 2 people
per table

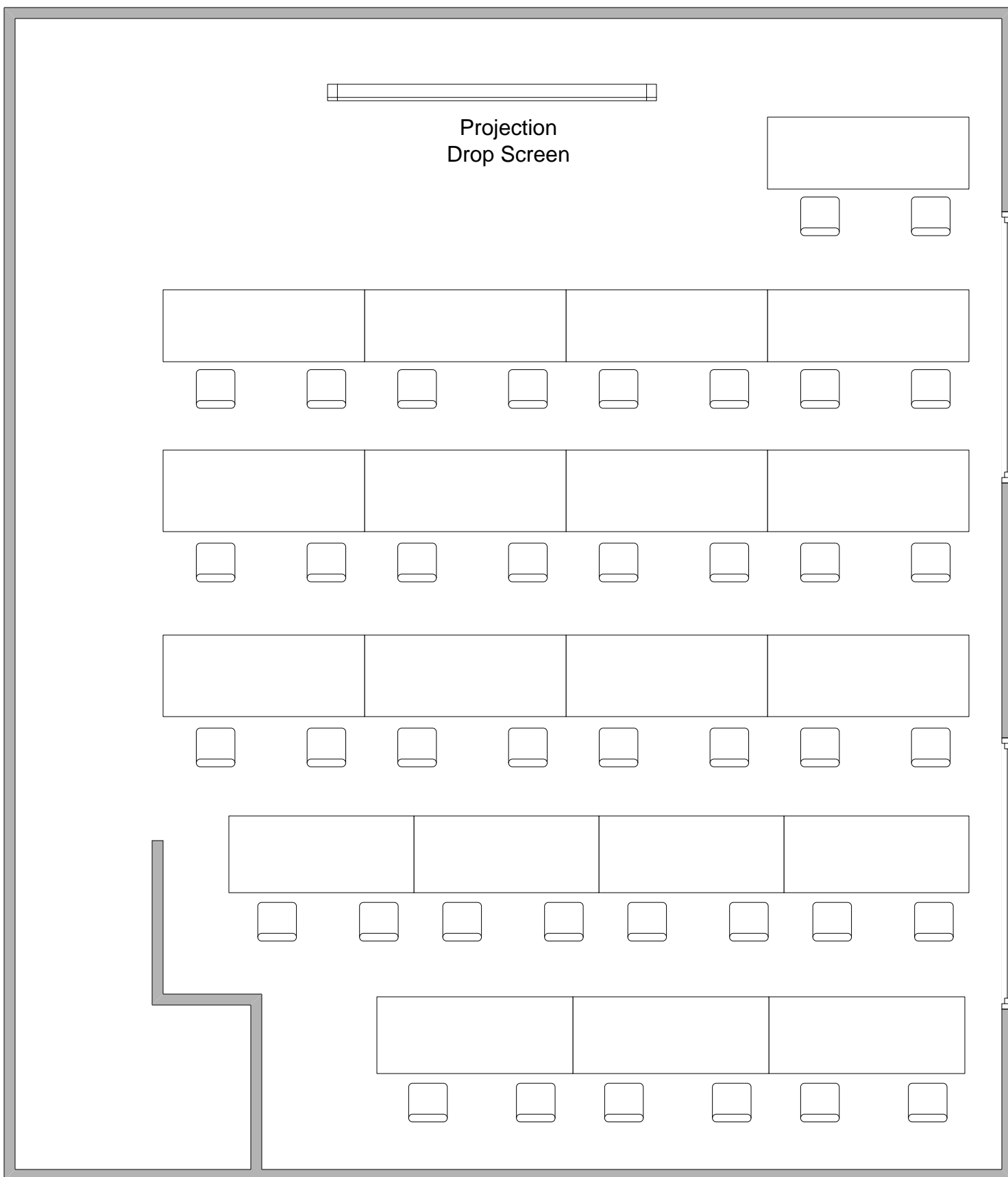





Room 30 ft. x 35 ft.

Theater Style
Maximum (75) people
with existing chairs.
Additional chairs may
be rented at additional
cost to client.

(75) Chairs
1'9"x1'9"
footprint



(20) Desk
Tables 5'x4'
one-sided.
Seats 2 people
per table

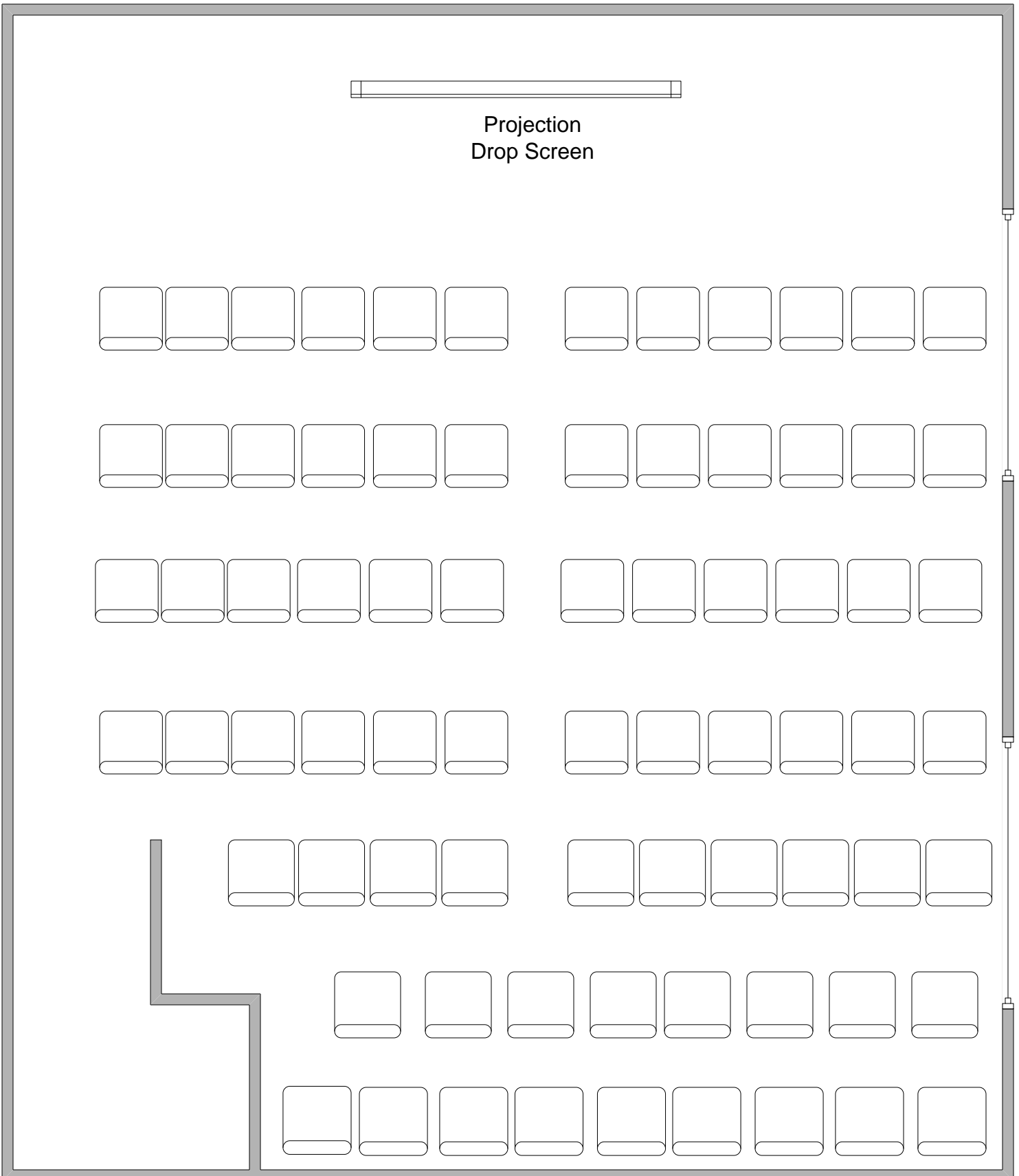



**Annual Meeting
Configuration**

(75) Chairs
1'9"x1'9"
footprint



(20) Desk
Tables 5'x4'
one-sided.
Seats 2 people
per table

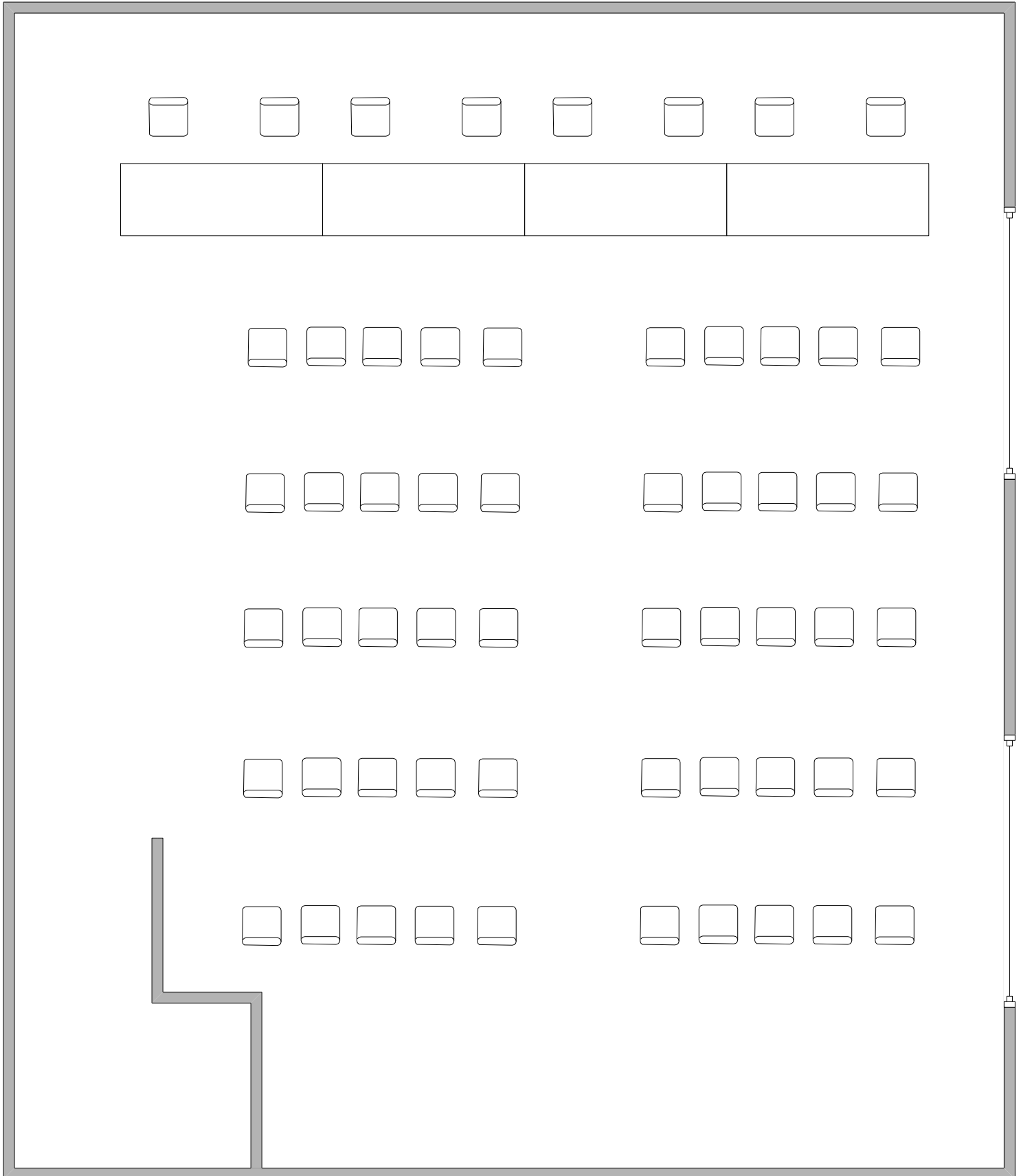

Room 30 ft. x 35 ft.

(75) Chairs
1'9"x1'9"
footprint



(20) Desk
Tables 5'x4'
one-sided.
Seats 2 people
per table

